

NOČNÍ STOLEK č.F133/DC

500x502x358
DUB CINK

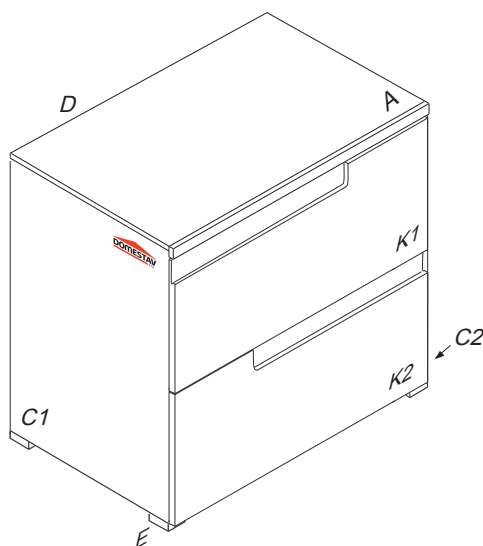

Kolíky vždy narazte nejprve do otvorů ve hranách dílců, je nutné je zarazit se stejným přesahem. V případě, že některý kolík přesahuje, je nutné jej zakrátkit. Dílce srážejte kladivem pouze přes dřevěnou podložku.

1/3

	3 x1	4 x1	6 x30		22 x8	43 x8
	3mm	4mm	8x35mm		3,5x16mm	EU 6x16mm
60 x24	61 x24		70 x16		80 x2	92 x50
15mm	DU 2		5x40mm		300mm	1,4x20mm
						filc

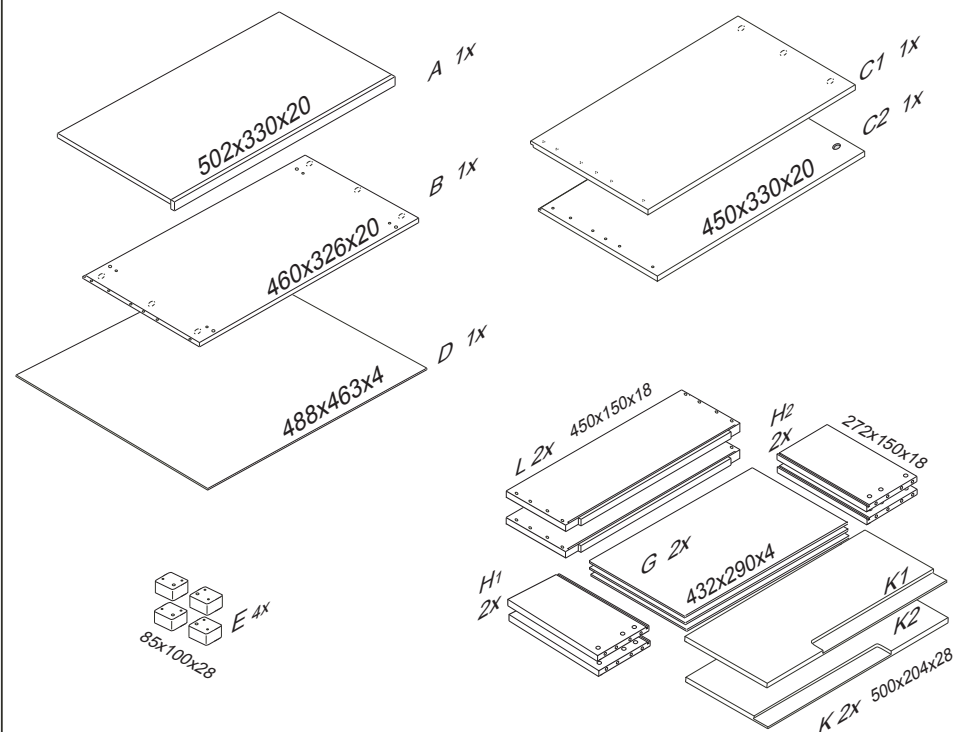

F133/DC

1

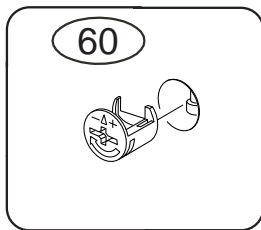

2

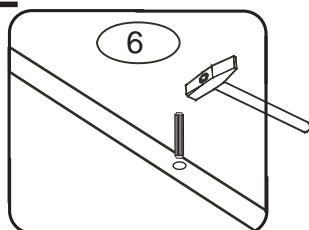

3

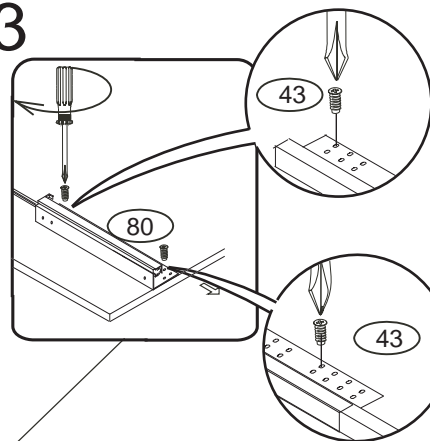

4

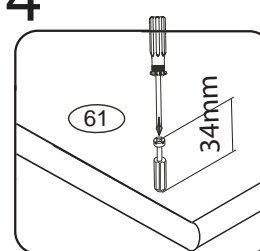

5

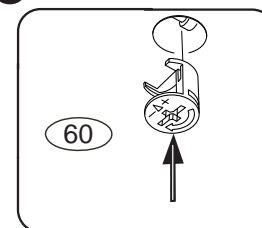

2/3

6

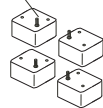
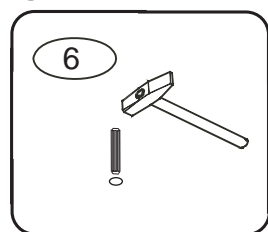

E

9

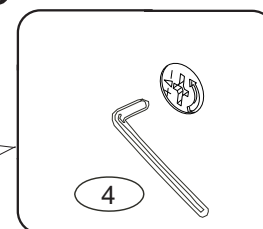

8

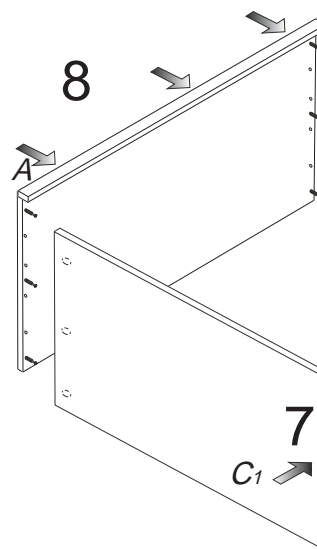

7

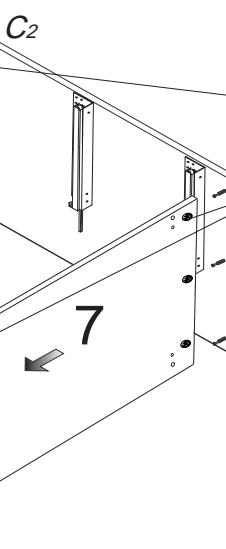

C1

C2

F133/DC

3/3

11

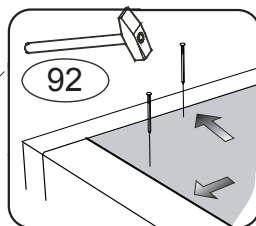

13

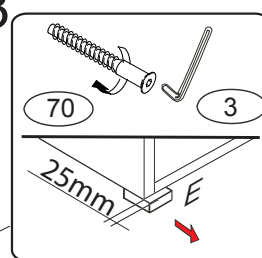

Pro případ nebezpečí, že by stolek
přepadával vpřed, je možné nožku
přemontovat do předsunuté pozice.



ZÁSUVKU
POLOŽTE DNEM NAHORU

19

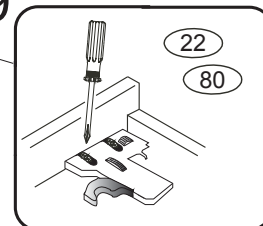

NOČNÍ STOLEK
POLOŽTE ČELEM DOLŮ

14

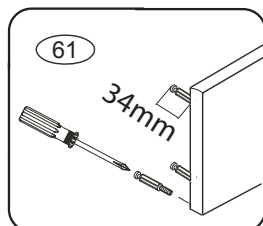

15

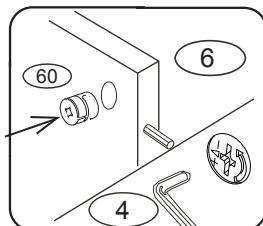

18

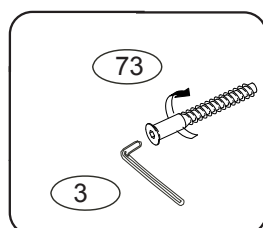

12

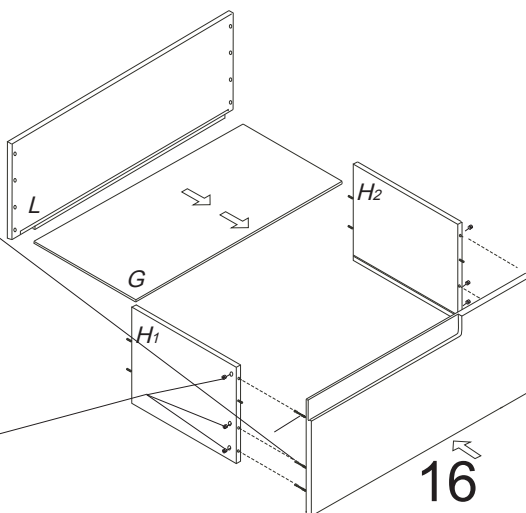

16

17

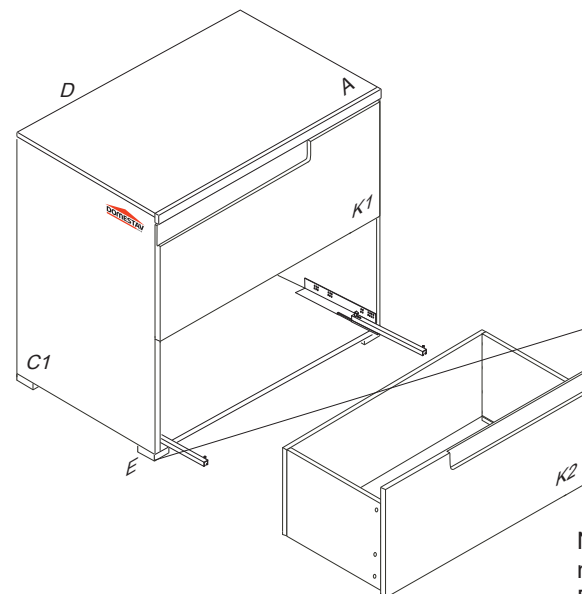
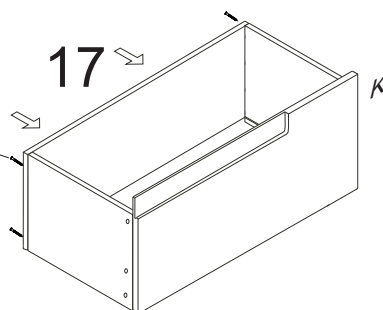

21

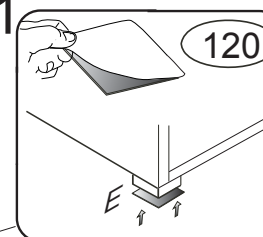

Na vysunuté pojezdy
nasadte zásuvky.
Polohu zásuvek upravte
červeným kolečkem na spoje.

20

